

# The Company

**Airflow** is the UK's leading manufacturer of Spraybooths and has built a name that is industry-renowned for Spraybooths of the highest quality, reliability and performance.

For over two decades **Airflow** has been committed to the design and manufacture of innovative products for the Finishing industries.

We recognise that our commitment to innovation has been central to our growth and success, and we will continue to invest in design and manufacturing technology to ensure that **Airflow** continues to supply product solutions that meet the needs of ever-changing customer and regulatory demands.

Specify **Airflow** Spraybooths by name and be assured you will be choosing the best product, backed by the UK's leading company.

# Waterwash Booths

At **Airflow** we have recognised that business is increasingly competitive and trying to find savings is equally as hard. We also recognise that the solution to this problem is not to choose an inferior Spraybooth in order to reduce initial price, risking costly unreliability. The right solution is to specify an **Airflow** Spraybooth and optimise performance in terms of both reliability and long-term production costs.

**Waterwash** Spraybooths from **Airflow** - giving you, the customer the best quality Spraybooths at the most economic price.

**Airflow** has developed the range of **Waterwash** Spraybooths that have all the quality and benefits expected from an **Airflow** Booth, but have been designed for easy installation to reduce costs.

The Booth Chamber is supplied fully assembled and **Airflow** provide a final assembly and installation service as required.

Alternatively all you then need to do is employ a local contractor to undertake any other necessary work to take the ducting through either the roof or wall, unless this is work you are able to undertake yourselves.

# Cartridge Fan

The **Airflow** Patented Cartridge Fan is unique - the best fan in the industry.

Spraybooth emissions produce a particularly harsh environment which can cause the premature failure of conventional fans.

Therefore we specifically designed our own fan for Spraybooth ventilation, the **Airflow** Cartridge Fan.

Manufactured in-house to ISO 9001 standards, performance tested, and CE marked before despatch, the **Airflow** Cartridge Fan is fitted as standard to all **Airflow** Spraybooths.

An integral casing provides a totally sealed protection of the drive mechanism and bearings against in-duct contamination, ensuring 100% reliability.

The Cartridge configuration enables the drive mechanism to be removed for routine maintenance without disrupting the fan housing or ventilation ducting.

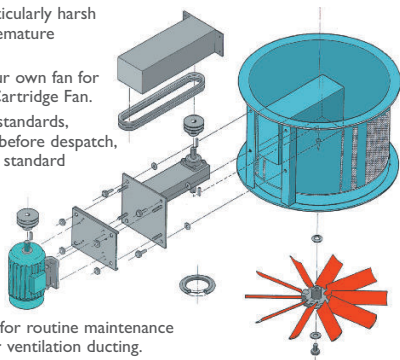

## Airflow Spraybooths are designed to give the highest standards of quality and operating reliability.

**Airflow** only uses the highest quality heavy-duty 1.2mm galvanised sheets which are formed with 50mm returns to give individual panels and the overall Booth strength and rigidity.

This is achieved by an industry unique overlapping panel construction design.

Each panel is individually designed and CNC punched to +/- 0.1mm accuracy which means the Waterwash Booth fits together solidly, quickly and accurately with the minimum of fixings required.

The **Airflow** Booth is solid and free-standing with smooth internal faces which assist cleaning.

**Airflow** supply as standard the highest quality lock formed ducting in kit form for ease of installation.

**Airflow** Booths have a quality look and finish which complements any factory environment.

### A Waterwash Booth includes:

- 1.1 metre deep Canopy to chosen width.
- 1.15 metre Washing Chamber to chosen width
- **Airflow** patented Cartridge Fan, with 3-phase, 415V, 50Hz, non-flameproof motor.
- Telemecanique non-flameproof DOL starters.
- Washing Chamber supplied fully assembled.
- Full and detailed installation and maintenance instructions.

### Additional-cost options:

**Lighting** - for both canopy roof or side panels is available.

**Forward Canopy Extension** - to increase the effective working depth by 1.1 metre increments.

**Canopy Divider** - to create multiple work stations within one booth.

**Ducting Kits** - a range of options are available for wall or roof extract, please see schedule for details.

### Legislation

**Airflow** Booths provide an air velocity through the Booth that meets and surpasses the requirement of HSG178.

**Airflow** Fans are legal and comply with the Machinery Directive (89/392/EEC).

Technical files and risk assessments are held at **Airflow** to ensure our and your compliance with legislation.

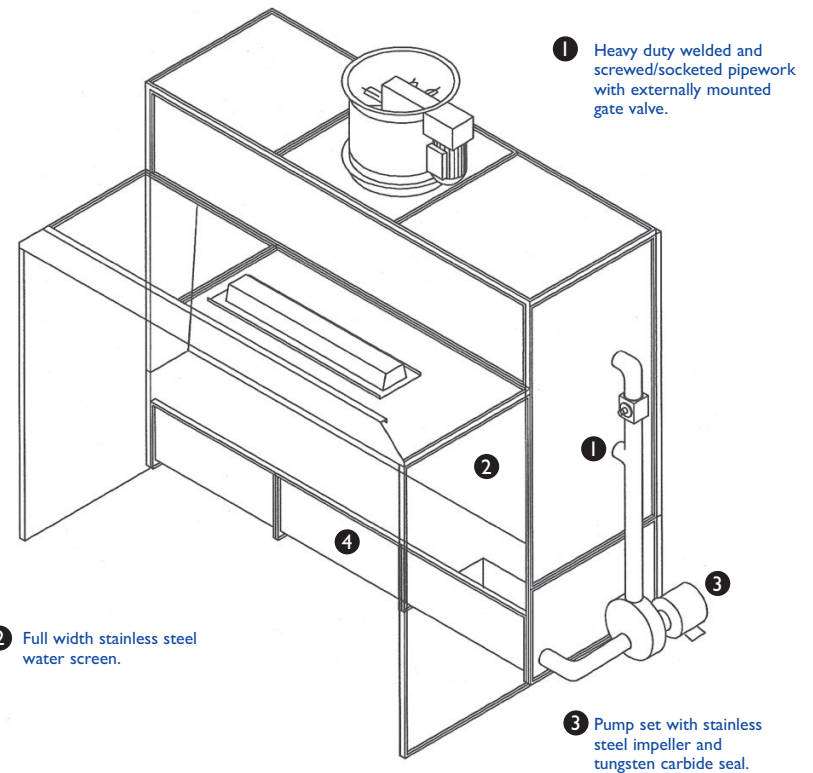

2 Full width stainless steel waterproof DOL starters.

1 Heavy duty welded and screwed/socketed pipework with externally mounted gate valve.

3 Pump set with stainless steel impeller and tungsten carbide seal.

4 2mm mild steel fully welded and two-coat epoxy painted tank.

5 High pressure water jets act against the extracted air flow to provide a highly efficient cleaning action.

6 Standard Canopy Height of 2.2 metres means more headroom and space for hanging bars or tall products.

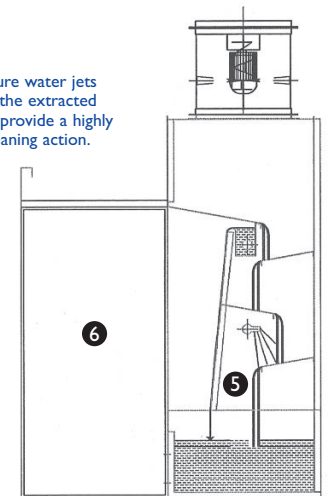

6

5